



# INSTRUCTION BULLETIN

No. 9008242  
Machine: M20, T20,  
M30  
Published: 03-2011  
Rev. 00

**NOTE: DO NOT DISCARD the Parts List from the Instruction Bulletin. Place the Parts List in the appropriate place in the machine manual for future reference. Retaining the Parts List will make it easier to reorder individual parts and will save the cost of ordering an entire kit.**

*NOTE: Numbers in parenthesis ( ) are reference numbers for parts listed in Bill of Materials.*

Installation instructions for **kit number 9008248**

## SYNOPSIS:

This kit contains the parts needed to replace the front wheel support housing on M20 / M30 / T20 machines.

Please follow step-by-step instructions.

## SPECIAL TOOLS / CONSIDERATIONS: NONE

(Estimated time to complete: 1.25 hours)

## PREPARATION:

1. Park the machine on a clean level surface, turn off the machine, remove the key, and set the parking brake.

**FOR SAFETY: Before leaving or servicing machine, stop on level surface, turn off machine, and remove key.**

2. Slightly loosen the front wheel lug nuts.
3. Chock the back of the rear tires and jack up the front end of the machine. Refer to *MACHINE JACKING* in the *MAINTENANCE* section of the Operators Manual for additional information about safely jack up the machine.
4. Position two jack stands at the designated locations under the front of the machine.

**FOR SAFETY: When servicing machine, block machine tires before jacking machine up. Use a hoist or jack that will support the weight of the machine. Jack machine up at designated locations only. Support machine with jack stands.**

5. Remove the front wheel from the machine. Set the front wheel and lug nuts aside.
6. Remove the hub assembly from the hydraulic drive motor. Set the hub assembly, cotter pin, key, and slotted nut aside. Refer to Fig. 1.

7. Remove the hardware holding the hydraulic motor to the wheel support housing and carefully lower the hydraulic motor from the wheel support housing. **Do Not** disconnect any hydraulic connections when removing the hydraulic drive motor. Set the mounting hardware aside. Refer to Fig. 1.
8. Disconnect the hydraulic cylinder from the wheel support housing. Discard the hex nut and spacer. Set the washer aside. Refer to Fig. 1.
9. Remove wheel support housing from the machine. Discard both the steel and felt flat washers. Set the shoulder bolt, slotted hex nut, and cotter pin aside. Refer to Fig. 1.
10. Remove the steel flat bar from the wheel support housing. Set the steel flat bar and mounting hardware aside. Refer to Fig. 1.
11. Remove both grease fittings from the wheel support housing. Set the grease fittings aside. Discard the wheel support housing. Refer to Fig. 1.
12. Remove the hardware holding the hydraulic cylinder to the frame of the machine and carefully lower the hydraulic cylinder. **Do Not** disconnect any hydraulic connections when removing the hydraulic cylinder. Discard the 4.00 hex screw, spacer, and hex nut. Set the washer aside. Refer to Fig. 1.

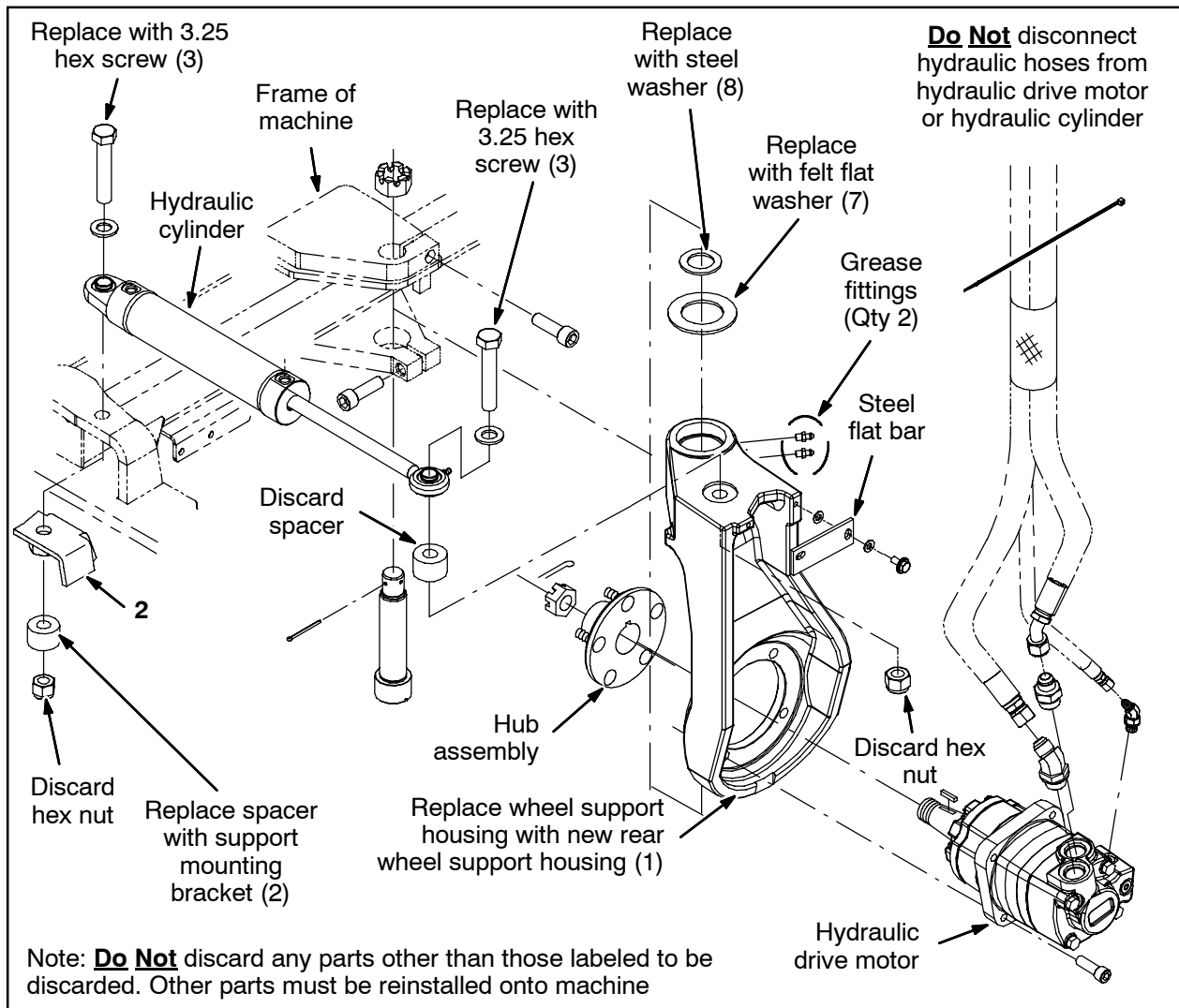

**FIG. 1**

**INSTALLATION:**

1. Apply a light coat of blue Loctite® onto the threads of one hex screw (3).
2. Place the support mounting bracket (2) onto the frame of the machine (where the spacer was previously located) and use a hex screw (3) to secure the hydraulic cylinder and the support mounting bracket to the frame of the machine. Torque hex screw to 240-260 ft. lbs.
3. Tighten the grease fittings into the new rear wheel support housing (1). Refer to Fig. 1.
4. Use the shoulder bolt, slotted hex nut, and cotter pin to install the rear wheel support housing (1), felt flat washer (7) and steel flat washer (8) onto the machine. Refer to Fig. 1.
5. Apply a light coat of blue Loctite onto the threads of the remaining hex screw (3).
6. Use a hex screw (3) to install the hydraulic cylinder onto the rear wheel support housing (1). Torque hex screw to 240-260 ft. lbs. Refer to Fig. 1.
7. Install the steel flat bar onto the rear wheel support housing (1). Refer to Fig. 1.
8. Place the key into the shaft of the hydraulic motor and install the hydraulic motor and hub assembly onto the rear wheel support housing (1). Refer to Fig. 1.
9. Install the front wheel onto the machine.
10. Remove the jack stands from under the machine and lower the machine to the floor.

® Loctite is a registered trademark of the Henkel Corporation.

11. Tighten the lug nuts.
12. Add lubricant to the rear wheel support housing (1).
13. Start and test the machine. Test the steering. The machine should steer easily in both directions.

---

**Bill Of Materials For Housing Kit, Drive, Front, F/1037940 Rep - 9008248**

Ref.	Tennant Part No.	Description	Qty.
▽	9008248	Housing Kit, Drive, Front, F/1037940 Rep	1
▲	1 1064086	Housing, Sppt, Rear Wheel	1
▲	2 1060521	Bracket, Mtg, Sppt	1
▲	3 77345	Screw, Hex, .75-10 X 3.25, G5	2
▲	4 374560	Seal, Drive, Rear, Grease Cav *	1
▲	5 51338	Bearing, Cup, 2.56D 0.55W *	2
▲	6 51339	Bearing, Cone, 1.38B 0.71W *	2
▲	7 374563	Washer, Flat, 2.16B 3.50D .16, Felt	1
▲	8 54051	Washer, Flat, 1.39B 2.12D .13, Stl	1

*\* NOTE: Components are already installed in the Housing, Sppt, Rear Wheel.*

TENNANT COMPANY  
P. O. Box 1452  
Minneapolis, MN 55440-1452